



ASI *Visual Display
Products*

THE FLEXIBILITY TO CREATE VISUAL DISPLAY SYSTEMS WITH QUALITY AND PERFORMANCE THAT EXCEED EXPECTATIONS

Since 1959 our goal has been to provide visual display products and services that meet and exceed aesthetic and performance requirements. Only ASI Group designs and manufactures high quality visual display products that are easy to install and require little maintenance. All inquiries welcome and if you don't see a solution here please do not hesitate to reach out to us. Welcome to the new ASI Group—the world's leading manufacturer of partitions, washroom accessories, lockers, and visual display products. Explore the new standard for basis of design in Visual Display Products.

HOW TO ORDER

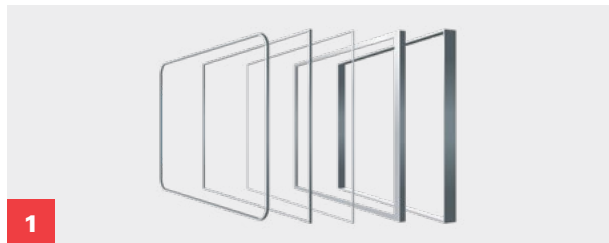

Select your Trim Series

Choose a trim series that meets your aesthetic and performance requirements.

P. 4-7 **Trim Series**

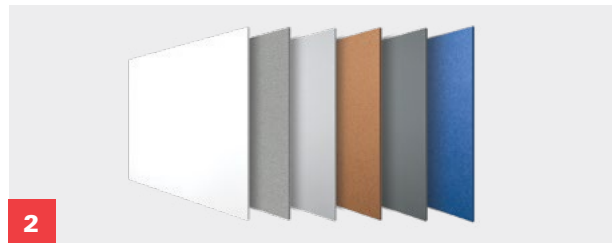

Select your Surface Options

Select from a variety of writing and tackboard surface options.

P. 8-9 **Porcelain Writing Surfaces**

P. 12 **Fabric Tac[®] Tackboards**

P. 10-11 **Glass Writing Surfaces**

P. 12 **Vinyl Tac Tackboards**

P. 12 **Cork Tackboards**

P. 14-15 **Forbo[®] Tackboards**



WE ARE LASER FOCUSED ON DELIVERING EXACTLY WHAT YOU NEED—WHERE AND WHEN YOU NEED IT.

ASI Group's Global Reach—see how on pages 26-27.



U.S. Green Building Council (USGBC)
ASI Visual Display Products is committed to continuously delivering the most environmentally friendly products to the global marketplace.



3

Select your Sizes & Options

Select from multi board construction or vertical or horizontal sliding options.

P. 17 Multi Board Construction

P. 18-19 Sliders

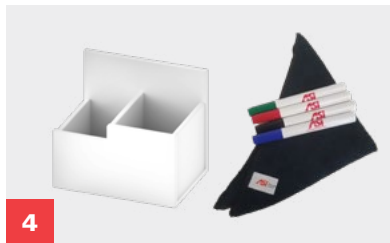

4

Select your Accessories

Choose from a variety of display and marker rails, and accessories.

P. 22-23 Rails & Accessories

Additional Visual Display Products

Select additional product such as directories, cases, and mobile units.

P. 16 Mobile Units

P. 20 Installation Guide

P. 21 Coat Racks

P. 23 Directories & Cases





TRIM SERIES

We offer a wide selection of aesthetic options to meet any interior design and performance requirements, ranging from our innovative 9500 series—Elite Reveal floating trim, 9100 series square or radius corners, to our 9300 and 9800 series trim.

TRIM SERIES



SERIES 9500 ELITE REVEAL

The limitless versatility of our Elite Reveal framing series is unmatched. Our innovative 1/8" reveal comes standard on all installations and is available in any number of finishes—available in Porcelain and Forbo®. When your design calls for stylish, minimal aluminum framing, Elite Reveal creates striking, crisp, clean installations that float off your finished wall surface.

- Minimal Framing
- 1/8" Reveal



SERIES 9100

This slim and durable framing system is offered with a square or radius corner, and is available in 5 standard sizes as well as other custom sizes.

- Square and radius frames come in a clear anodized aluminum
- Sophisticated narrow face trim
- 9/32" exposed frame



SERIES 9800

The most popular trim series, engineered to provide a permanent, direct-to-the-wall installation, at an economical price. With its 3/4" frame, Series 9800 does not overpower the room but complements and harmonizes with modern decor schemes.

- Subtle Framing
- 3/4" Exposed Frame
- Available as a knock-down, multipanel option for customizable assembly on-site.



SERIES 9300

A prominent, heavy-duty framing series, providing a permanent application with a retro flair. With its 1-1/2" wide face protruding 1/4" off the finished writing surface, Series 9300 units are available in a variety of finishes.

- 1-1/2" Exposed Frame



EDGE GRIPS WITH STAND OFFS – GLASS ONLY

Our Edge Grips provide a stylish and simple way to mount glass markerboards to your finished wall surface. A total of four Edge Grips are installed above and below the glass markerboard, allowing it to stand off the wall.



HIDDEN Z-BRACKET – GLASS ONLY

Our Hidden Z Bracket mounting system for glass markerboards provides a frameless appearance. Hidden Z Brackets offer a minimalistic look, free of any visible hardware, while securing the glass markerboard to the finished wall surface.

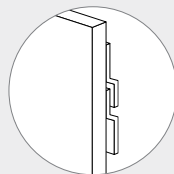

WRITING SURFACE OPTIONS

PORCELAIN SURFACES

ASI Porcelain writing surfaces are made for busy offices and boisterous classrooms, providing a super-smooth writing surface that erases like magic and will not scratch or stain for as long as it is in use—guaranteed. It is the most popular writing surface for chalkboards and whiteboards, providing superior writability, durability, and erasability.



Shipped In
48
HOURS

- Lifetime Warranty (on writing surface for the life of the building)
- Can be written on with dry-erase markers
- Optimum erasability—and easy to maintain
- Scratch, chemical, and fire resistant—will not release toxic fumes in the event of fire

- Greater color contrast
- Standard is high gloss white
- Safe and clean—releases no harmful chemicals into the environment
- Available in Series 9100 Radius and Square, 9300, 9500 Elite Reveal, and 9800 pre-framed and knock-down frames

PORCELAIN COLOR SELECTION:

GLOSS MARKERBOARDS



White High Gloss 29 White Low Gloss 29L

High and low gloss boards to be used with dry-erase markers.

ULTRA MATTE PORCELAIN



Green Ultra Matte 06 Black Ultra Matte 11

Ultra matte porcelain for use with chalk.

Actual colors may vary slightly from those shown due to limitations in the printing process.



CUSTOM GRAPHIC BOARDS*:

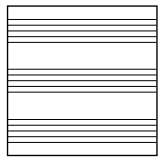

Music Lines

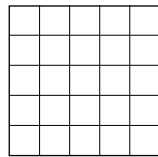

Graph Coordinates

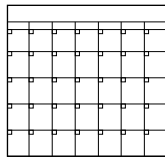

Calendar

*Other custom graphics available—please call for additional information.

Sizes:	4' x 3'	4' x 4'	4' x 6'	4' x 8'	4' x 10'	4' x 12'	5' x 3'	5' x 4'	5' x 6'	5' x 8'	5' x 10'	5' x 12'
Series 9500	■	■	■	■	■	■	■	■	■	■		
Series 9100	●	●	●	●	●	●	●	●	●	●	●	●
Series 9300	■	■	■	■	■	■	■	■	■	■	■	■
Series 9800	■	▲	▲	▲	■	■	■	■	■	■	■	■

Series 9800 allows for having multiple tray choices at the bottom of the frame, or having the bottom section match the other three sides. A variety of display rails, flag holders, map rails, and hooks can also be accommodated on this frame.

■ = Square Corner ● = Radius Corner ▲ = Available to be shipped in 48 hours

WRITING SURFACE OPTIONS

GLASS SURFACES

The performance of ASI Glass Markerboards is unmatched in the industry, allowing designers and architects the ability to showcase interiors with this striking product line. Its clean lines and superior erasability are achieved using only ASI's UltraClear™, 1/4" tempered glass, also known as museum glass. ASI Glass Markerboards may be optionally specified with a backing that allows for magnetic applications when used with rare earth magnets.

Features:

- Tempered glass at 1/4" low iron UltraClear™
- Sizes up-to 48" x 144" & 60" x 144". Custom Sizes available upon request
- Custom graphics available
- Optional magnetic backing—Steel backer able to receive magnetics

Available in:

- Floating
- Edge Grip

AVAILABLE MOUNTING OPTIONS:



FRAMELESS GLASS
with edge grip stand-offs



FRAMELESS GLASS
with hidden Z track bracket



GLASS COLOR SELECTION:

STANDARD COLOR



White 6529



A full range of colors are available upon request.

Unlimited color selection available, please contact us for pricing.

Sizes:	4' x 3'	4' x 4'	4' x 6'	4' x 8'	4' x 10'	4' x 12'	5' x 3'	5' x 4'	5' x 6'	5' x 8'	5' x 10'	5' x 12'
Edge Grip	■	■	■	■	■	■	■	■	■	■	■	■
Hidden-Z Bracket	■	■	■	■	■	■	■	■	■	■	■	■

Colors subject to change.

Actual colors may vary slightly from those shown due to limitations in the printing process.



Shipped In
48
HOURS

NATURAL CORK

There is no other material, either man-made or natural, with all the properties and characteristics that are unique to natural cork: light-weight, rot resistant, compressible and recoverable, expandable, fire resistant in its natural state, impermeable, soft and buoyant. Because of this unparalleled combination of properties, natural cork has a wide variety of applications. With its light-weight honeycomb structure and its flexible membrane, cork is the ideal material for bulletin boards.

Available in:

- Series 9100, 9300, and 9800 Square Series

Features:

- Environmentally friendly
- Rapid renewable resource

Sizes:	4' x 3'	4' x 4'	4' x 6'	4' x 8'	4' x 10'	4' x 12'	5' x 3'	5' x 4'
Series 9100	■	■	■	■	■	■		
Series 9300	■	■	■	■	■	■	■	■
Series 9800	■	▲	▲	▲	■	■	■	■

■ = Square Corner ▲ = Available to be shipped in 48 hours

TACKBOARD SURFACE OPTIONS



FABRIC TAC*

Our new “Eco Fabric” is made from 100% recycled polyester crepe, designed for recyclability. It’s a subtle intermingling of colors across a clean, refined surface that offers a classic look that is ideal for a wide range of end uses.

Available in:

- Series 9100 (square and radius), 9300 and 9800

Features:

- Optimum functionality
- Material resistant to 100,000 rubs

FABRIC COLOR SELECTION:



*Fabric Tac available in a wide range of colors from virtually any fabric manufacturer. See available colors at www.asi-visualdisplayproducts.com.

Fabric is buy to order. Custom fabrics are available upon request at additional cost.

Sizes:	4' x 3'	4' x 4'	4' x 6'	4' x 8'	4' x 10'	4' x 12'	5' x 3'	5' x 4'
Series 9100	■ ●	■ ●	■ ●	■ ●	■ ●	■ ●		
Series 9300	■	■	■	■	■	■		
Series 9800	■	■	■	■	■	■		

■ = Square Corner ● = Radius Corner

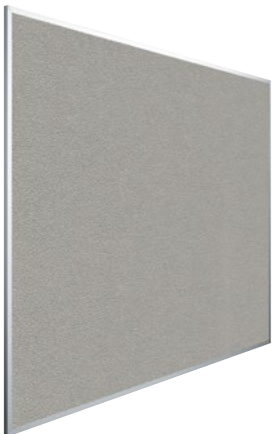

VINYL TAC

Vinyl has a lightly embossed simple, timeless, and classic woven effect that is available in four standard colors.

Available in:

- Series 9100 (square and radius), 9300 and 9800

Features:

- Incredibly durable finish
- Cleanable
- Fire resistant

VINYL COLOR SELECTION:



White Irish Linen Salem Grey Embassy Charcoal Embassy Taupe

Additional colors available, please contact us for pricing and availability.

Sizes:	4' x 3'	4' x 4'	4' x 6'	4' x 8'	4' x 10'	4' x 12'	5' x 3'	5' x 4'
Series 9100	■ ●	■ ●	■ ●	■ ●	■ ●	■ ●		
Series 9300	■	■	■	■	■	■		
Series 9800	■	■	■	■	■	■		

■ = Square Corner ● = Radius Corner



FORBO®

Forbo® Bulletin Board is produced from natural and renewable raw materials. A combination of oxidized linseed oil, resin, and finely ground cork gives Forbo® its flexibility and resilience. This combination results in a product with exceptional durability and a sustainable footprint.

Self-healing properties

Its strength and resilience make Forbo® the ideal material for pin boards, notice boards, and all other surfaces where ideas and information are exchanged. The board material retains its grip and doesn't crumble like traditional soft boards as the pinholes close after extraction of the pins.

Practical & hygienic

Forbo® does not attract dust and has bacteriostatic properties. This makes it a practical solution in classrooms and a hygienic choice in healthcare environments where "get well" messages can be pinned behind the bed.



FORBO® BULLETIN BOARD COLOR SELECTION:

The choice for environments where a functional, washable, tackable surface is needed.

Standard Colors

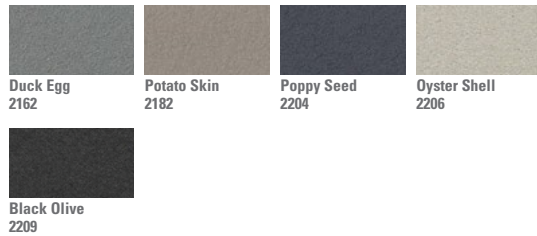

Optional Colors



All colors shown are available in 48" high rolls.
 2182 Potato Skin, 2186 Blanched Almond, and
 2166 Nutmeg Spice are also available in 71" high rolls.

Sizes:	4' x 3'	4' x 4'	4' x 6'	4' x 8'	4' x 10'	4' x 12'	5' x 3'	5' x 4'	5' x 6'	5' x 8'	5' x 10'
Series 9500 Elite	■	■	■	■	■	■	■	■	■	■	■
Series 9100	■	■	■	■	■	■	■	■	■	■	■
Series 9300	■	■	■	■	■	■	■	■	■	■	■
Series 9800	■	■	■	■	■	■	■	■	■	■	■

5'x6 and 5'x8 available in limited colors, please see Forbo® color chart.
 1/4" roll form in 4' and limited 6' height colors.

■ = Square Corner ● = Radius Corner

Forbo® is a registered trademark of Forbo Flooring Systems.
 Actual colors may vary slightly from those shown due to
 limitations in the printing process.

MOBILE UNITS



MOBILE UNITS

Mobile Units are constructed of welded steel framing with a durable baked enamel paint finish. Ball type casters are installed to each foot assembly to provide ease of movement.

ASI Mobile Units are offered in 2 surfaces providing various combinations of markerboards utilizing porcelain or glass to suit your individual requirements.

Available in:

- Porcelain or glass
- All units double sided
- 48" x 72" or 48" x 96" (horizontal) and 54", 60", and 66" (max vertical) sizes
- Powder coated gray frames
- Silent ball type caster—with brakes



MULTI BOARD CONSTRUCTION

WITH SPLINE

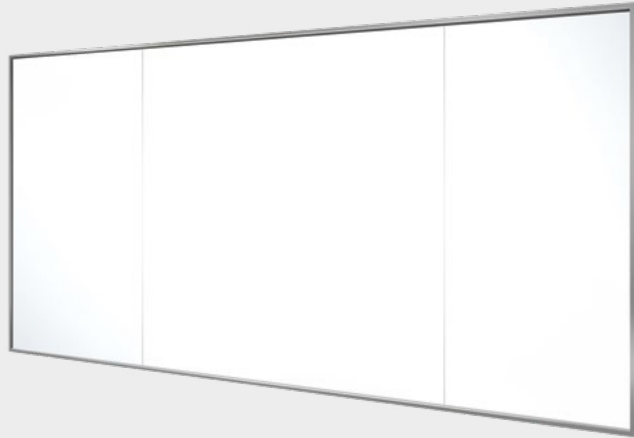
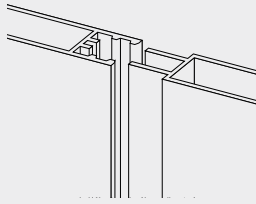

For applications when a large continuous writing surface is needed we offer markerboards that are equipped with our spline edge system. A markerboard with a spline edge can be connected to another marker board, with the reciprocal edge, by snapping the two edges together during installation. This allows for a large beautiful surface with minimal visual interruptions.

WITH DIVIDER H BRACKET

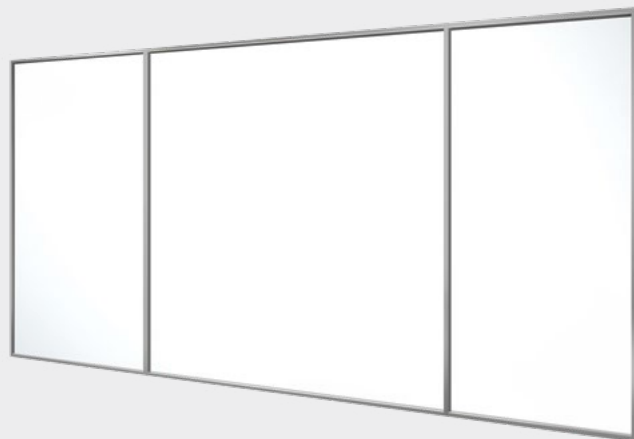
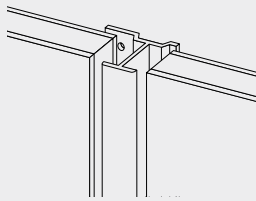

This system allows multiple markerboards to be connected together using an H Bracket that serves as a divider between each board. This H Bracket slides over the markerboard's edges during installation.

HORIZONTAL AND VERTICAL SLIDERS

Horizontal and vertical sliding units present a unique method of installing additional writing surfaces where limited wall space occurs. Sliding panels move laterally or vertically in front of a fixed back panel to substantially increase writing area. For ease of operation, panels are top suspended and slide easily over the extruded aluminum track on nylon rollers.

Features:

- Available in a wide variety of surface options and finishes
- Easy maintenance and operation
- Boards operate quietly

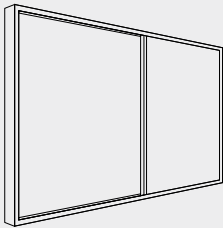

SINGLE HORIZONTAL SLIDER

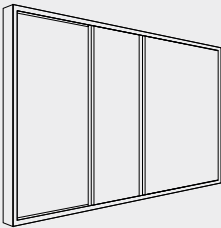

DOUBLE HORIZONTAL SLIDER

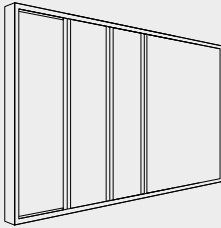

TRIPLE HORIZONTAL SLIDER

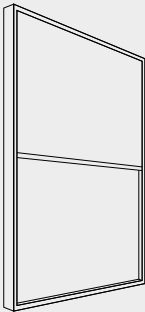

SINGLE VERTICAL SLIDER

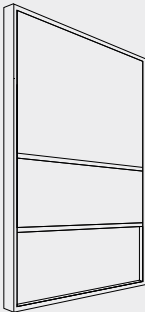

DOUBLE VERTICAL SLIDER

PERIMETER SCHOLARS
INTERNATIONAL



For more info
www.perimeterscholars.org
psi@perimeterinstitute.ca
Talk to us!

Courses
• Statistical Physics
• Condensed Matter
• Field Theory I & II
• Quantum Field Theory
• Particle Physics

Review Courses

- ★ Standard Model
- ★ Condensed Matter
- ★ Quantum Foundations
- ★ Cosmology
- ★ Gravitational Physics
- ★ Quantum Gravity
- ★ Quantum Information
- ★ String Theory
- ★ Particle Physics

Explorations Courses

- Condensed Matter
- String Theory
- Quantum Information
- Cosmology
- Particle Physics
- Numerical Relativity



INSTALLATION

EASI INSTALL

Save on shipping and handling cost as well as on installation time.

Our unique and innovative “Easy Install” system allows us to ship a board (framed on three sides) along with a bottom tray that is not attached to the board. This makes for a much slimmer cost effective shipping container, and now comes the Easy Install part. An installer will mount the unattached tray directly to a wall, anchoring it at 16" centers. A specially designed slot in the anchored tray serves as a receptacle into which the unfinished side of the board easily slides in.

Once the board is in place it is fastened at the top by either through a map rail or by using L-clips. Easy to ship, easy to install, and a cost effective way to manage inventory.

- Allows distributors to stock 3 different styles of boards (*same board—2 optional trays*)
- Board is installed up to 10% faster
- Stronger installation
- No gluing required
- Easier handling

INSTALLATION

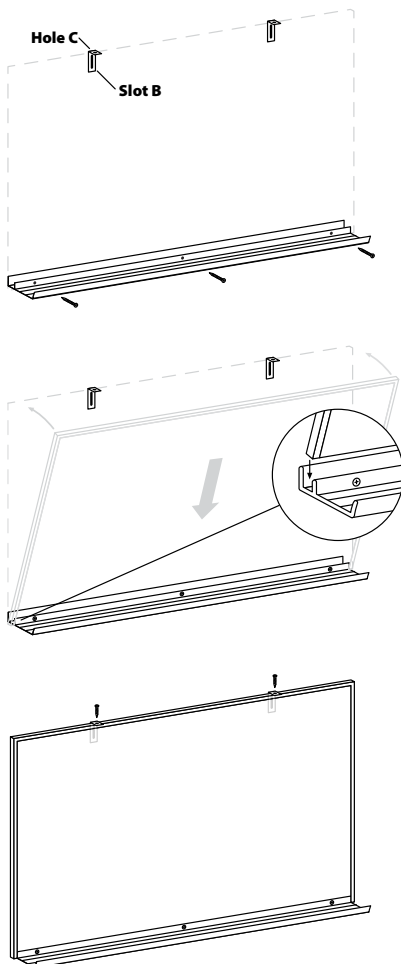

- 1 Fasten tray securely to wall (*provided loose*).
- 2 Remove clips from hardware kit.
- 3 Locate studs—if applicable—and fasten clips through slot B into studs (wall).
Note: larger boards may have 3 clips.
- 4 Set board in tray.
- 5 Tap down clips to sit on top of board. Using screws removed in step 1, fasten clips to board through hole C.
Note: screws are self drilling, use electric drill with Robertson #2 bit to install.

COAT RACKS

COAT RACKS

STUDENT LINE

ASI Student Line Coat Racks are constructed using the finest materials available to provide a system that is both strong and durable.

- Units are finished with a high performance electrostatically applied powder coating to ensure years of worry-free maintenance.
- Solid impact resistant ABS hooks are available in 5 colors for use on various models.
- Hooks are spaced at 6" on center and each lineal foot of coat rack will provide 2 students with ample storage room.
- Standard Installation* – Coat racks are designed to be wall-mounted, easily and economically.
- Mounting heights can be easily changed to accommodate changing classroom requirements.



STL1000 ◆

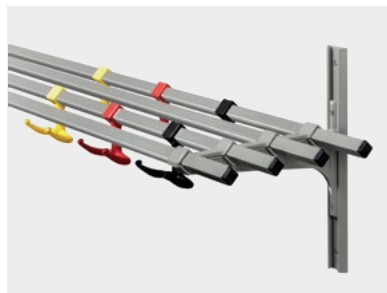

STL1001 ◆



STL2001 ◆

STUDENT LINE RACK COLOR SELECTION:



STL - Black

STL - Gray

STUDENT LINE HOOK COLOR SELECTION:



Hook - Black

Hook - Gray

Hook - Red

Hook - Yellow

Hook - Blue

RAILS & ACCESSORIES

DISPLAY & MARKER RAILS

ASI offers an assortment of display rails all available with a number of accessories—map hooks, roller brackets, or flag holders.



Magnetic Surface Mounted



Flat Tray



Angled Tray



1" Display Rail

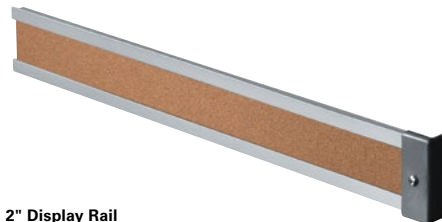

2" Display Rail

ACCESSORIES

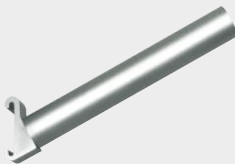

Flag holder for
1" map rail

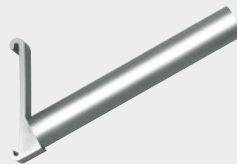

Flag holder for
2" map rail



Roller Bracket



Map hook for
1" map rail

ENCLOSED CASES & TROPHY CASES



SLIDING GLASS BULLETIN DIRECTORY

Ideal frame type for larger units, this unit has 1/4" thick sliding glass doors and is able to be made in larger sizes without the need for a center mullion, offering a clean unobstructed view of the entire face of the board. The units are supplied with a ratchet lock and 2 keys. This unit is custom made to your choice of frame color and backing type.

Glass Enclosed Units:

- Available in all panel types
- Hinged and sliding glass doors available
- 1/8" acrylic glass standard on hinged units
- Full length piano hinge on hinged units
- All fastenings concealed within units
- 1/4" tempered glass standard on sliding door units



HINGED DOOR BULLETIN DIRECTORY

Our most popular and versatile frame type, the hinged door unit is available with a wide choice of glazing, and a cylinder lock and 2 keys are standard. Available in all frame finishes and background choices, the hinged door unit is custom made to your exacting specifications.



TROPHY CASES

Wall mounted trophy cases come standard with 2 adjustable glass shelves, locking sliding doors, and 2 keys. Available in 6", 8", or 12" deep melamine or laminate frame in a variety of wood grain exterior finishes, with Forbo®, Natural Cork, or FabricTac® background choices.

Recessed display cases are made to the same exacting specifications as our wall mounted units and incorporate a recessed mounting trim kit. Refer to our surface selector guide for a full choice of finishing options.



Map hook for
2" map rail



Cloths & Markers

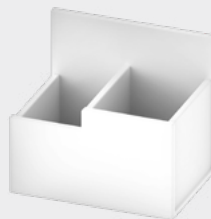

Caddy

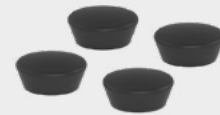

Magnetics

HOW TO ORDER

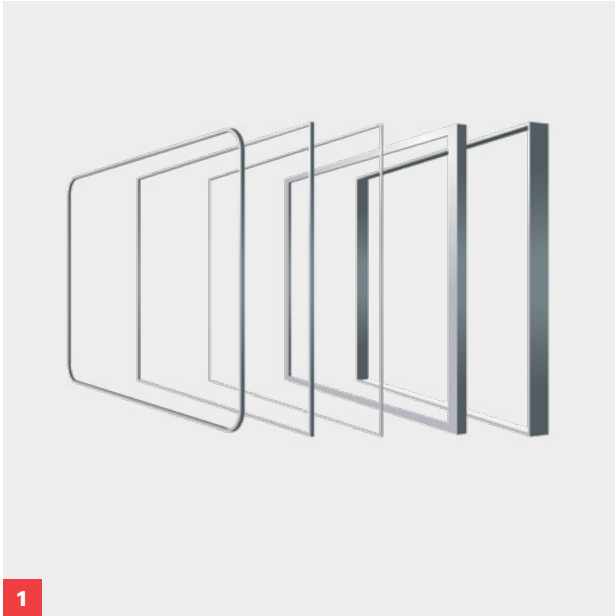

1

Select your Trim Series

Choose a trim series that meets your aesthetic and performance requirements.

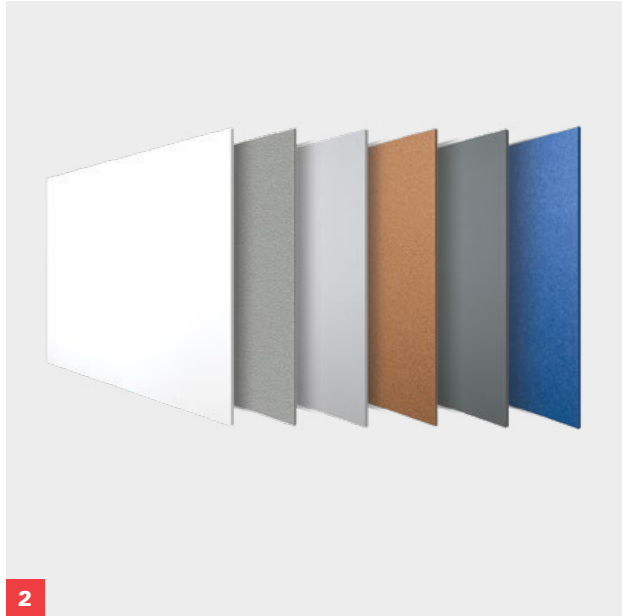

2

Select your Surface Options

Select from a variety of writing and tackboard surface options.

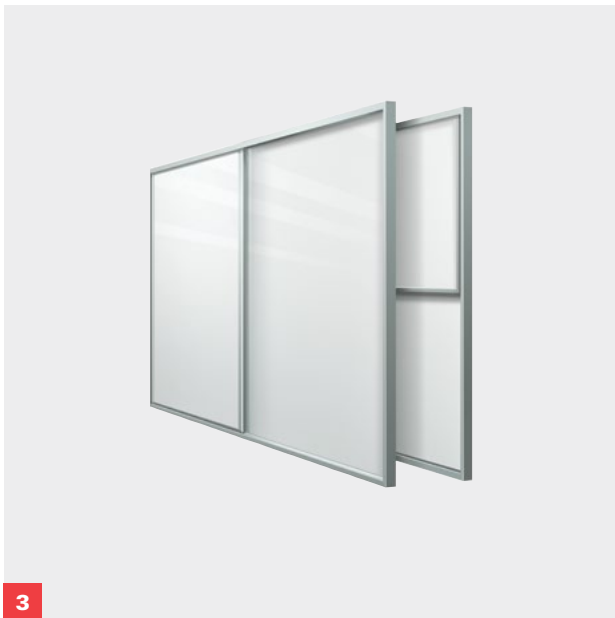

3

Select your Sizes & Options

Select from multi board construction or vertical or horizontal sliding options.

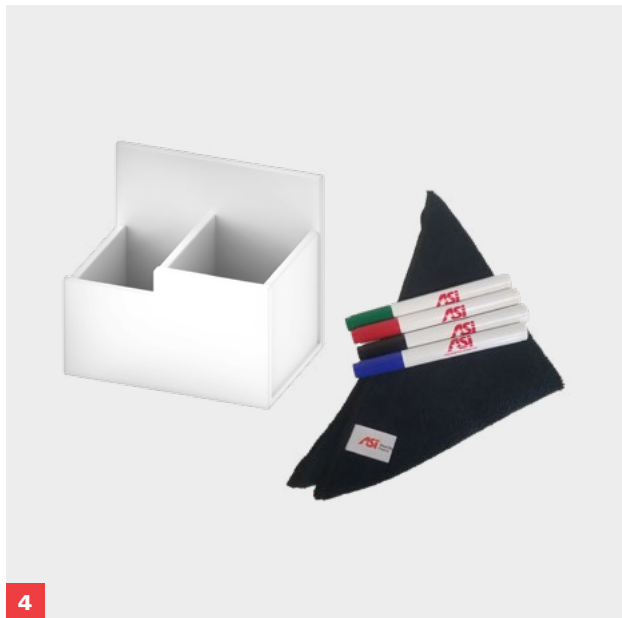

4

Select your Accessories

Choose from a variety of display and marker rails, and accessories.

SO WHY CHOOSE US? THE ANSWER IS **SIMPLE**

Only ASI Group designs, engineers, and manufactures fully integrated washroom accessories, partitions, lockers, and visual display products from one source.



Shipped In
48
HOURS

We are laser focused on delivering you exactly what you need—when you need it. Visit asi-visualdisplayproducts.com for details. No one beats our 48 hour delivery.

WHO WE ARE

The ASI Group is known for innovative products, speed to market, and the widest offering of materials and products in the industry.

Our family of companies work together with one mission in mind—“To make our customers successful by providing value that exceeds price and an excellent service experience.”



1 Glendon College, Toronto, Ontario



TOILET PARTITIONS

ASI offers the most comprehensive collection of plastic, plastic laminate, phenolic, Integrated Privacy™ stainless steel, and powder coated partitions from one source.



WASHROOM ACCESSORIES

The world's leading manufacturer of commercial washroom accessories. We offer the most comprehensive selection of washroom accessories available anywhere.



**WE ARE LASER FOCUSED ON DELIVERING EXACTLY WHAT YOU NEED—
WHERE AND WHEN YOU NEED IT.**

With operating units and offices in the USA, Canada, Australia, Belgium, UK, Middle East, and Mexico, along with sales in more than 50 countries, our ability to serve is not limited by geography.

Our broad scope helps meet the needs of healthcare, education, office, and retail buildings, as well as airports, stadiums, government offices, cultural centers, and hotel/restaurant operations.

SALES IN OVER 50 COUNTRIES **385+** DOMESTIC AND INTERNATIONAL SALES REPRESENTATIVES **1,000+** HIGHLY SKILLED EMPLOYEES **>1.3** MILLION SQ. FT. MANUFACTURING & OFFICE FACILITIES

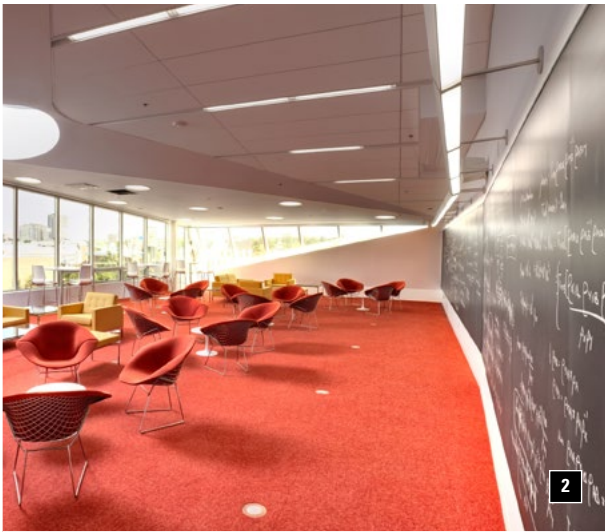

2



4

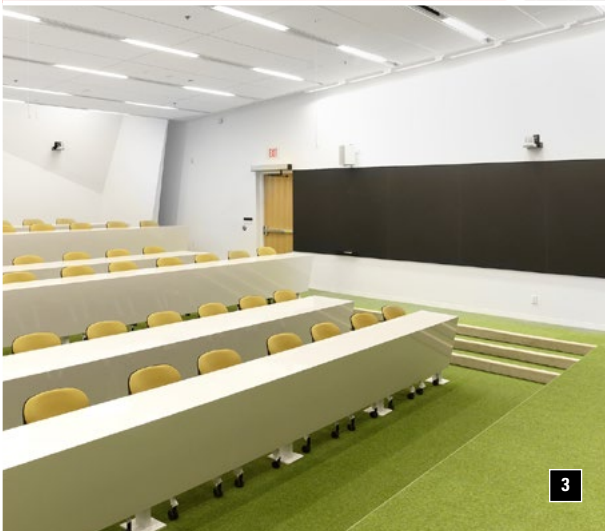

3

2 Perimeter College: Sky Room, Decatur, Georgia

3 Perimeter College: Sky Room, Decatur, Georgia

4 Glendon College, Toronto, Ontario



STORAGE SOLUTIONS

A wide range of colors and materials including steel, solid plastic, and Compact HPL lockers.



VISUAL DISPLAY PRODUCTS

Through constant research, innovation, and development, we design and manufacture high quality visual display products that are easy to install and require little maintenance.



Phone: 905.822.4287
Fax: 905.823.6885
Web: asi-visualdisplayproducts.com

© 2024 ASI Visual Display Products